



THIS BROCHURE PROVIDED BY CRAIG DELGER - LUXURY REAL ESTATE EXPERT

Powered by Data, Technology, and Local Expertise



4314 US Highway 89 S, Livingston MT 59047

\$1,750,000
Acres: ± 11.002
MLS#: 392570

INTRODUCTION

Welcome to Pine Creek Farm, located in the heart of beautiful Paradise Valley! Just 15 minutes south of Historic Livingston, Pine Creek Farm is an 11-acre Certified Organic Farm, perfect for your sustainable lifestyle. This working farm includes 3 year-round producing green houses, packaging facility, cold storage, seeding shed, numerous production outbuildings, an oversized two-car heated garage with outdoor storage, highway-frontage farmstand, a productive chicken and duck flock producing more than 15 cartons of eggs per week, and acres of established vegetable production. Current crops include seasonal lettuces, spinach, kale, Swiss Chard, Bok choy, beets, radishes, tomatoes, black currants, potatoes, and herbs of all varieties. Pine Creek Farm's potential is just waiting for your vision to bring the property to its fullest potential. Bring your horses to make this your picturesque horse property, or utilize the Zoning and Covenant allowances to create a more expansive commercial property. Zoning and Covenants allow for highway directed retail and signage. Some ideas include use as a Vacation Rental Retreat, further expanding the farm operation, dispensary and grow facility, floral boutique, and a combination art studio-gallery. Irrigation rights are included in the sale of this property and assistance is available to take up the mantle of the farm to ensure the USDA Organic Certifications are easily continued. Pine Creek Farm is surrounded in every direction with panoramic views of the Gallatin and Absoraka Range Mountains, prominently featuring Black Peak and Mt. Delano to the east. This piece of paradise features a 2967 sqft farmhouse, with 4 bedrooms and 2 baths. Centrally located in Paradise Valley, you are just minutes to the abundant outdoor recreation available in Paradise Valley, including the Yellowstone River, where plenty of Blue-Ribbon Trout Fishing and boat launch locations abound. Numerous entertainment and music venues are also just minutes way: Sage Lodge, Chico Hot Springs, Pine Creek Lodge, and more! With easy access to Livingston, Bozeman, and the North Gate of Yellowstone National Park, Pine Creek Farm is waiting for just the right person to create their perfect Montana Lifestyle!

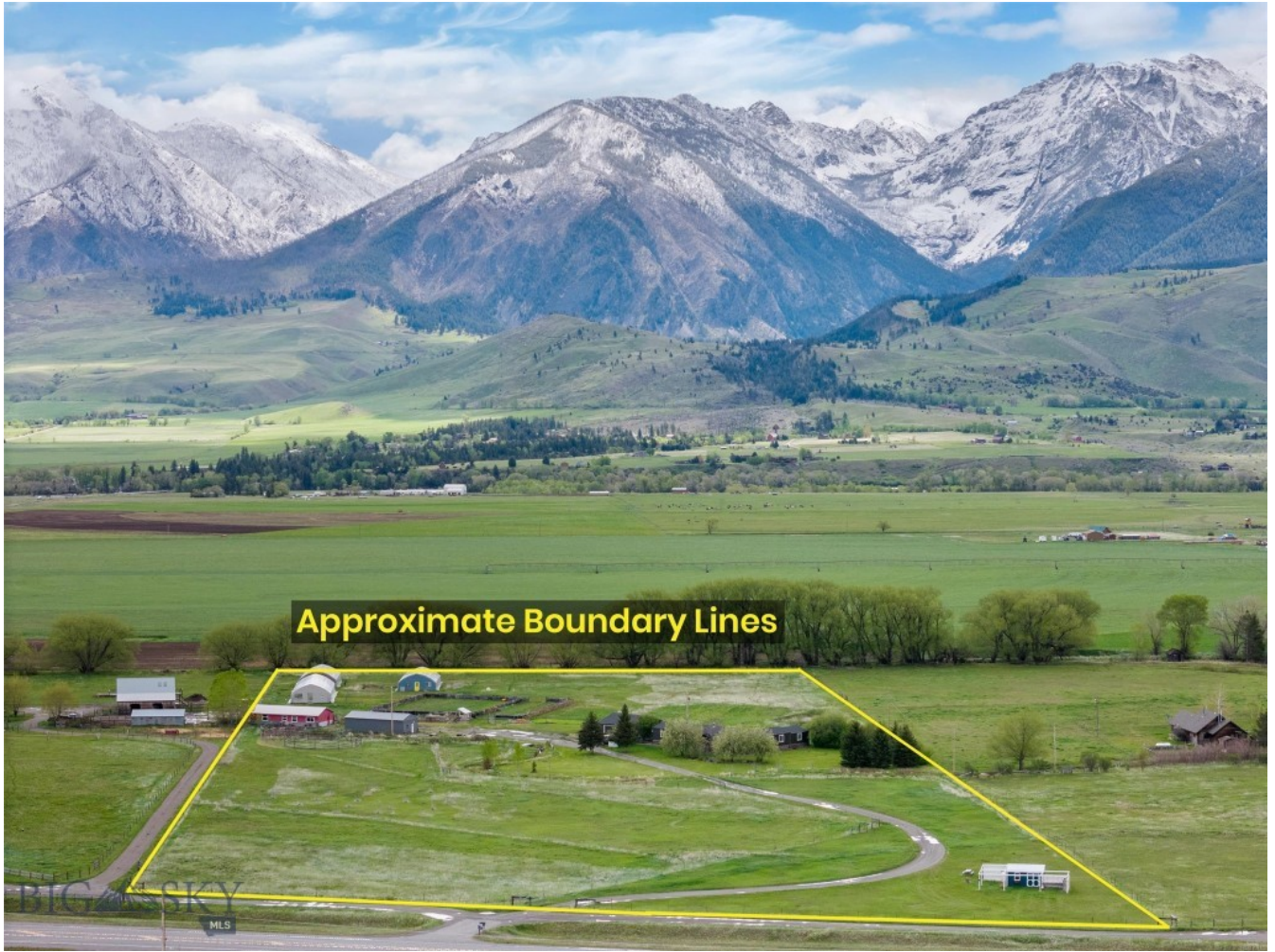

Approximate Boundary Lines

FEATURES

Status:	Active
Type:	CommercialSale
Acres:	± 11.002
Listing Date:	2024-05-29
Listing Agent:	Chase Heiland of Keller Williams Montana Realty

Year Built:	1990
Heating/Cooling:	CeilingFans

LOCATION



Address: 4314 US Highway 89 S, Livingston MT 59047

PHOTOS



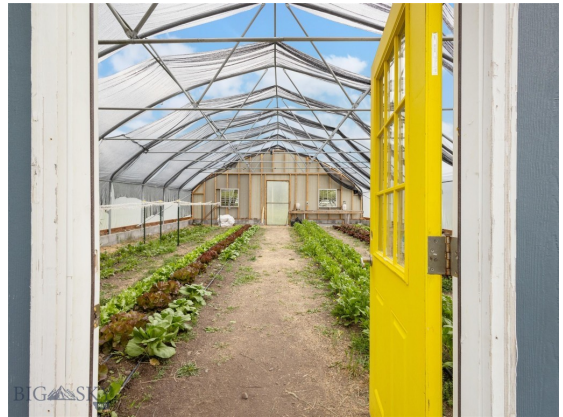







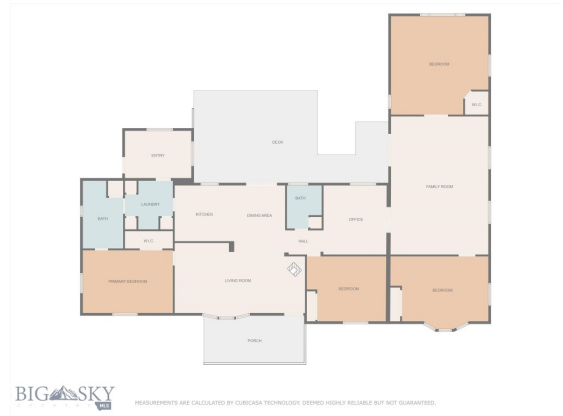







LIVINGSTON LIFESTYLE



Livingston, Montana is a historic train town from the late 1880's that has attracted cowboys, ranchers, artists, and the rich and famous who are enamored by the scenery of this area of southwestern Montana. Livingston has been featured in movies like A River Runs Through It, The Horse Whisperer, and numerous TV series and commercials.

Historic Downtown Livingston has lively restaurants and shops, some of which have been around since the late 1800' s. Livingston is known for fly fishing, cross-country skiing, horseback riding, river rafting and numerous museums, art galleries and restaurants.

When it comes to outdoor recreation the town of Livingston is surrounded by four beautiful mountain ranges, and offers the Yellowstone River, Shields River, and numerous stream and spring creeks for an abundance of outdoor activities. Bridger Bowl, a home-grown, nonprofit community ski area operating since 1955 is located 29 miles from Livingston. Big Sky Resort is 68 miles away and is also frequently recognized as one of the world's best ski resorts, most affordable ski resort, and best ski resort for families. Yellowstone National Park(2.2 million acres) is located 50 miles south of Livingston.

With a population of about 7,000 people, Livingston has the amenities and services buyers expect for a town of this size. Livingston is less than 20 minutes from Bozeman. The Livingston School District includes Elementary Schools, a Middle School, and a High School. The median price of a single family home in Livingston is 18% lower priced than single family homes in Bozeman and appeals to buyers seeking a smaller town, yet still want to be close to the amenities of Bozeman.

PARK COUNTY

Park County, Montana's estimated population is 16,438 with a growth rate of 1.94% in the past year according to the most recent United States census data. Park County, Montana is the 11th largest county in Montana. Park County has a total area of 2,813 square miles (1.8 million acres or 7,290 km²), of which 2,803 square miles (7,260 km²) is land and 10.4 square miles (27 km²) (0.4%) is water. The highest natural point in Montana, Granite Peak at 12,807 feet (3,904m), is located in Park County.



Paradise Valley is a major river valley of the Yellowstone River in southwestern Montana just north of Yellowstone National Park in the southern portion of Park County, Montana. The valley is flanked by the Absaroka Range on the east and the Gallatin Range on the west. The Yellowstone River, one of Montana's Blue Ribbon Trout Rivers, flows through Paradise Valley and is noted for world-class fly fishing in the river and nearby spring creeks such as DePuy Spring Creek. The valley hosts other natural wonders such as several natural hot springs, including Chico Hot Springs near Emigrant, Montana, La Duke Hot Springs near Gardiner, and Hunter's Hot Springs near Livingston. A small part of Yellowstone National Park is located in the extreme southern part of the county.

The northern end of Park County, Montana contains the Shields River Valley. The Shields River is a tributary of the Yellowstone River. It flows west, then south, between the Bridger Range to the west and the Crazy Mountains to the east, past Wilsall and Clyde Park. It joins the Yellowstone approximately 10 mi (16 km) northeast of Livingston, MT.

LUXURY REAL ESTATE EXPERT

Delger Real Estate sold over \$155 Million in Real Estate in 2016-2023. Recognized experts in Internet Marketing and Technology, Delger Real Estate are able to generate maximum exposure for their real estate listings. The result: according to ListHub, Delger Real Estate listings outperform 98% of the market. We encourage you to contact Craig to learn more about real estate in Livingston and the surrounding areas.

POWERED BY INTELLIGENT MARKETING, PROPRIETARY TECHNOLOGY, AND LOCAL EXPERTISE



Craig Delger
BROKER / OWNER
406.581.7504
craigdelger@gmail.com

v1.01-2024-07-03