

DELGER

— REAL ESTATE —

BOZEMAN MONTANA



Craig Delger
BROKER / OWNER
406.581.7504

THIS BROCHURE PROVIDED BY CRAIG DELGER - BOZEMAN REAL ESTATE EXPERT

Powered by Data, Technology, and Local Expertise



86 W Granite Peak, Bozeman MT 59718

\$959,000

Acres: ± 0.2

MLS#: 399055

INTRODUCTION

Better than new 4-bedroom, 2.5-bathroom home, nestled in the highly desirable Woodland Park neighborhood. Though only a few years old, this home has been meticulously maintained and upgraded, starting with brand-new hardwood floors that add warmth and elegance to every step you take. As you approach the home, you'll be greeted by lush, upgraded landscaping that creates curb appeal. Walk through the inviting formal entry with ample closet space and immediately feel home in the bright, open floor plan with large windows. The large closet space in the entryway ensures a clutter-free welcome. The living room, with its cozy gas fireplace, is perfect for both quiet evenings and lively gatherings. Adjacent, the expansive dining area can comfortably accommodate large dinner parties, making it an entertainer's delight. The heart of the home is the beautifully appointed kitchen, featuring a gas range, sleek range hood, oversized single basin sink, expansive kitchen island with seating, and a spacious built-in pantry. Just off the kitchen, the covered back patio invites you to extend your living space outdoors, perfect for BBQs and all-season entertaining. The southwest orientation of the patio provides the ideal balance of sunlight and shade for year-round comfort. Retreat to your generous main-level master suite, complete with a large walk-in closet offering enough room for a private laundry set-up (hookups in place). The en-suite bathroom boasts dual vanities and an impressive floor-to-ceiling tiled shower a spa-like escape. Upstairs, let your imagination soar with a versatile bonus room over the garage perfect for a home theater, game room, or home office. With plenty of space to customize, the possibilities are endless. Convenient second-level laundry and two large secondary bedrooms are thoughtfully positioned near the primary laundry room is equipped with ample cabinets and counter space for convenience. The third bedroom is near the guest bath with dual vanities and a roomy tub/shower, offering a quiet, private space. Each bedroom features top-down, bottom-up blackout blinds, ensuring comfort and relaxation for everyone. The fully fenced backyard provides the perfect sanctuary for pets and loved ones, combining privacy and peace of mind. Don't miss the opportunity to own this beautifully upgraded, better-than-new home in Woodland Park designed to meet your every need.



FEATURES

Status:	Active
Type:	Residential
Sub Type:	Single Family
Acres:	± 0.2
Water Features:	None
Listing Date:	2025-01-20
Listing Agent:	Tamara Williams of Tamara Williams and Company

Style:	Craftsman
Year Built:	2022
Beds:	4
Baths:	3
Appliances:	Dryer, Dishwasher, Disposal, Microwave, Range, Refrigerator, Washer
Heating/Cooling:	ForcedAir CentralAir, CeilingFans

LOCATION



Address: 86 W Granite Peak, Bozeman MT 59718

PHOTOS











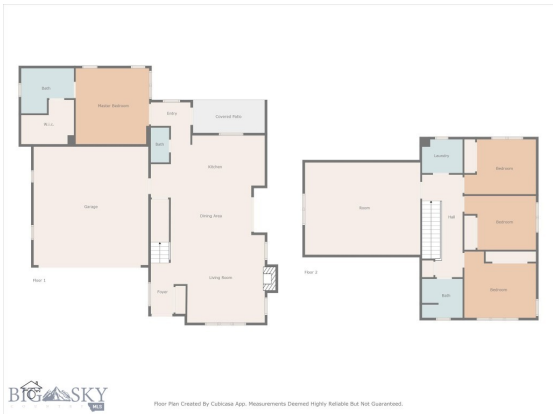



BOZEMAN LIFESTYLE™



Bozeman lifestyle is considered one of the most appealing in the West. Bozeman is routinely ranked as one of the best places to live, best places to retire, best place to raise a kid, best place to visit, best ski town, and best college town. Big Sky Resort is also frequently recognized as one of the world's best ski resorts, most affordable ski resort, and best ski resort for families.

Bozeman is known for its friendly people, sense of community, excellent schools and quality of life. The town has a western charm and a relaxed attitude. The Bozeman Quality Of Life index rates very well due to access to Outdoor Recreation, Amusement, Culture, Education, Medical, Religion, Restaurants and Weather. Bozeman has the cultural amenities of a local symphony and ballet, an energetic downtown restaurant and art scene, and the vibrancy of a college community. Located 16 miles north of Bozeman in the Bridger Canyon area is Bridger Bowl, a home-grown, nonprofit community ski area operating since 1955. Big Sky Resort is less than an hour away and is also frequently recognized as one of the world's best ski resorts, most affordable ski resort, and best ski resort for families.

When it comes to outdoor recreation Bozeman is surrounded by 6 different mountain ranges, which offer vast winter and summer recreational opportunities.

A world class destination for fly fishing, Bozeman is home to the world's most famous Blue Ribbon fly fishing rivers, spring creeks and lakes on Earth. The Yellowstone, Madison, Gallatin, Jefferson, Beaverhead, and Missouri rivers are all nearby.

Bozeman has 60 miles of "Main Street To Mountains" trail system in town, surrounded by 6.9 million acres of public land.

GALLATIN COUNTY

Located in a sweeping valley in the heart of the Rocky Mountains, Gallatin County is the most populated and fastest growing county in scenic southwest Montana. Gallatin Valley has a rich history. Native Americans referred to this area as the "Valley of Flowers". The name seems appropriate because of the great variety of wild flowers found on the mountainsides as well as in the valley. Gallatin Valley derives its name from the Gallatin River, one of the forks of the Missouri river that rises in Yellowstone Park. The Gallatin river, Jefferson river, and Madison river all merge at the town of Three Forks to form the Missouri River. Lewis and Clark named the rivers on their famous expedition to this part of the world in 1805.



There are approximately 1,682,048 acres (2,500 square miles) in Gallatin County including over 16,500 acres in surface water. Approximately 800,000 acres in Gallatin County are owned by the public and managed by several local and national agencies including the Bureau of Land Management, U.S. Forest Service, National Park Service, Montana Fish Wildlife & Parks, Montana Department of Transportation, Department of Natural Resources & Conservation and various local governments. The U.S. Forest Service is the largest land holder in Gallatin

County, currently managing over 665,000 acres. In addition to the Forest Service, various state departments manage approximately 61,000 acres. The Bureau of Land Management holds just over 9,000 acres and an additional 1,600 acres belongs to local governments. On the southern edge of Gallatin County is Yellowstone National Park. Yellowstone National Park is one of the world's primary wildlife preserves and has the greatest concentration of geysers and hot springs in America. Yellowstone National Park is 2,219,789 acres in size (larger than Rhode Island and Delaware combined). Over 97,600 acres of Yellowstone National Park is located within Gallatin County.

BOZEMAN REAL ESTATE EXPERT

Delger Real Estate sold over \$155 Million in Real Estate in 2016-2023. Recognized experts in Internet Marketing and Technology, Delger Real Estate are able to generate maximum exposure for their real estate listings. The result: according to ListHub, Delger Real Estate listings outperform 98% of the market. We encourage you to contact Craig to learn more about real estate in Bozeman and the surrounding areas.

POWERED BY INTELLIGENT MARKETING, PROPRIETARY TECHNOLOGY, AND LOCAL EXPERTISE



Craig Delger
BROKER / OWNER
406.581.7504
craigdelger@gmail.com

v1.01-2025-02-05