

DELGER

— REAL ESTATE —

BOZEMAN MONTANA



Craig Delger
BROKER / OWNER
406.581.7504

THIS BROCHURE PROVIDED BY CRAIG DELGER - BELGRADE REAL ESTATE EXPERT

Powered by Data, Technology, and Local Expertise



700 Mayfair, Belgrade MT 59714

\$765,000

Acres: ± 0.203

MLS#: 411463

INTRODUCTION

Welcome to 700 Mayfair in Belgrade, Montana a spacious and inviting five-bedroom, three-bathroom home designed for comfortable living and entertaining. Situated on a desirable corner lot across from a community park and baseball fields, this property offers the perfect blend of space, functionality, and location. The main level features an open dining area with access to a beautifully updated second-story deck overlooking the fully fenced and landscaped backyard, complete with mature trees, underground sprinklers, and recent landscaping improvements an ideal setting for relaxing and enjoying Montana summers. Inside, you'll appreciate numerous thoughtful upgrades throughout the home, including updated kitchen cabinets, countertops, appliances, upstairs flooring, interior paint, and refreshed primary bedroom closet doors. Additional improvements include newer upstairs windows, including the sliding glass door and kitchen window, plus updated fencing in the front section of the backyard. The fully finished basement provides additional living space with three bedrooms, a cozy gas fireplace, walk-in storage closets, and an oversized laundry room. An oversized two-car garage includes a built-in workbench and abundant storage space for tools, outdoor gear, and toys. Major updates such as the roof and AC unit provide added peace of mind, making this home truly move-in ready. Conveniently located just minutes from all Belgrade public schools, this one-of-a-kind property offers space, comfort, and an unbeatable neighborhood setting.



FEATURES

Status:	Active
Type:	Residential
Sub Type:	SingleFamilyResidence
Acres:	± 0.203
Water Features:	None
Listing Date:	2026-05-26
Listing Agent:	Kathy Simkins of Berkshire Hathaway - Bozeman

Year Built:	1993
Beds:	5
Baths:	3
Appliances:	Dishwasher, Disposal, Microwave, Range, Refrigerator, SomeGasAppliances, Stove
Heating/Cooling:	ForcedAir NaturalGas CentralAir, CeilingFans

LOCATION

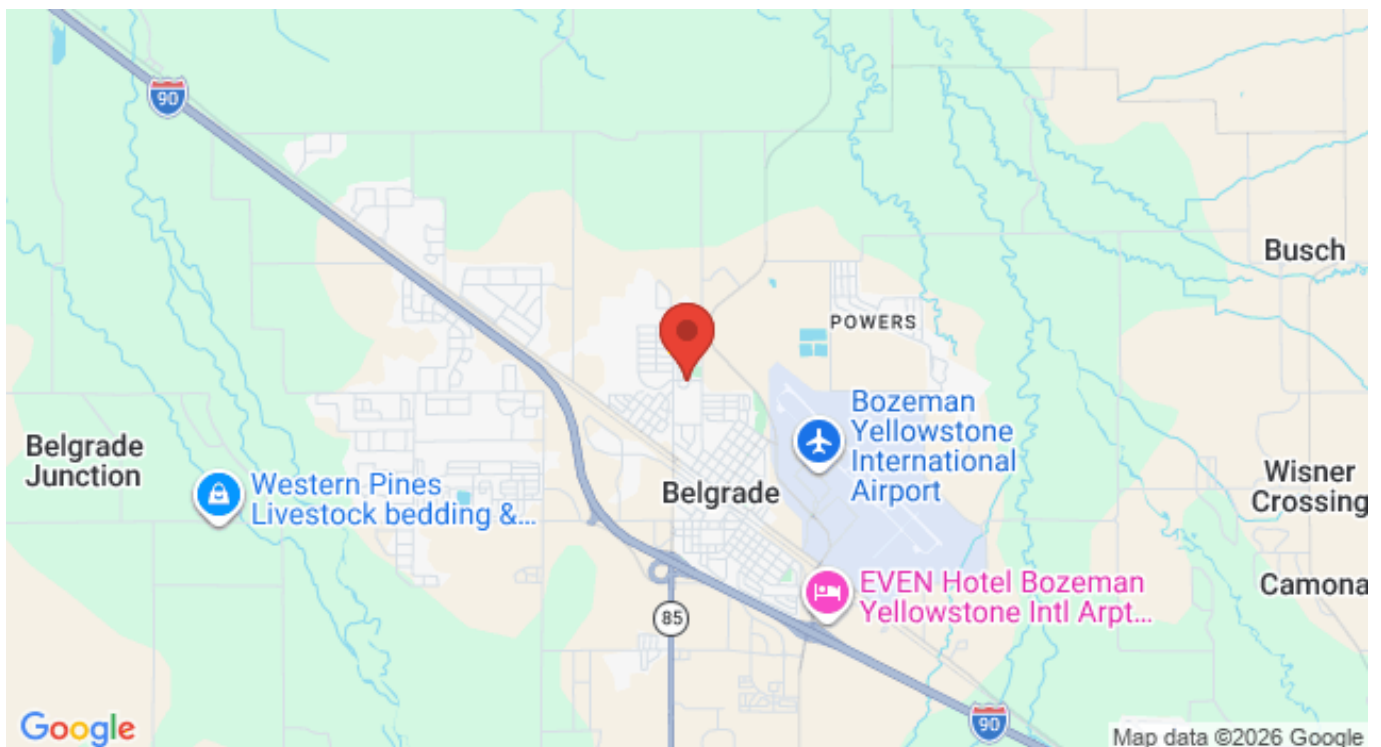

Address: 700 Mayfair, Belgrade MT 59714

PHOTOS











700 Mayfair Dr, Belgrade, MT 59714

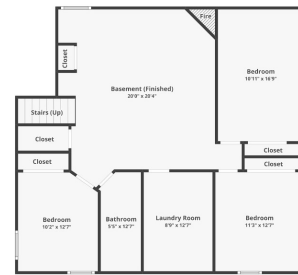

Basement
BIG SKY

Not guaranteed. Information provided for informational purposes only. Measurements are approximate, and square footage may include finished and unfinished areas.

700 Mayfair Dr, Belgrade, MT 59714



Floor 1
BIG SKY

Not guaranteed. Information provided for informational purposes only. Measurements are approximate, and square footage may include finished and unfinished areas.

BELGRADE LIFESTYLE



With a population of about 8,000 people, Belgrade has the amenities and services buyers expect for a town of this size. The Belgrade School District includes Elementary Schools, a Middle School, and a High School. Belgrade neighborhoods and surrounding areas are experiencing significant population growth, with numerous new subdivisions under development. Belgrade, Montana is located just 11 miles to the northwest of Bozeman, Montana making it a desirable location. Many Belgrade Homes for sale have views of the mountain ranges and open land surrounding the Gallatin Valley.

Homes in Belgrade offer convenient access to the Bozeman Yellowstone International Airport, and to the Interstate. Belgrade has a small downtown area with grocery stores, restaurants, and shopping. Belgrade is just over 10 minutes from Bozeman's N 19th Ave shopping district which includes stores like Costco, Target, etc.

When it comes to outdoor recreation Belgrade is surrounded by 6 different mountain ranges, which offer vast winter and summer recreational opportunities. Bridger Bowl, a home-grown, nonprofit community ski area operating since 1955 is located 24 miles from Belgrade. Big Sky Resort is 44 miles away and is also frequently recognized as one of the world's best ski resorts, most affordable ski resort, and best ski resort for families.

The world's most famous Blue Ribbon fly fishing rivers (Yellowstone, Madison, Gallatin, Jefferson, Beaverhead, and Missouri rivers) are all nearby making this area a world class destination for fly fishing. Yellowstone National Park (2.2 million acres) is located 90 miles south of Belgrade, Montana.

The median price of a single family home in Belgrade is 30% lower priced than single family homes in Bozeman and appeals to buyers seeking lower priced real estate, yet still want to be close to the amenities of Bozeman.

GALLATIN COUNTY

Located in a sweeping valley in the heart of the Rocky Mountains, Gallatin County is the most populated and fastest growing county in scenic southwest Montana. Gallatin Valley has a rich history. Native Americans referred to this area as the "Valley of Flowers". The name seems appropriate because of the great variety of wild flowers found on the mountainsides as well as in the valley. Gallatin Valley derives its name from the Gallatin River, one of the forks of the Missouri river that rises in Yellowstone Park. The Gallatin river, Jefferson river, and Madison river all merge at the town of Three Forks to form the Missouri River. Lewis and Clark named the rivers on their famous expedition to this part of the world in 1805.



There are approximately 1,682,048 acres (2,500 square miles) in Gallatin County including over 16,500 acres in surface water. Approximately 800,000 acres in Gallatin County are owned by the public and managed by several local and national agencies including the Bureau of Land Management, U.S. Forest Service, National Park Service, Montana Fish Wildlife & Parks, Montana Department of Transportation, Department of Natural Resources & Conservation and various local governments. The U.S. Forest Service is the largest land holder in Gallatin

County, currently managing over 665,000 acres. In addition to the Forest Service, various state departments manage approximately 61,000 acres. The Bureau of Land Management holds just over 9,000 acres and an additional 1,600 acres belongs to local governments. On the southern edge of Gallatin County is Yellowstone National Park. Yellowstone National Park is one of the world's primary wildlife preserves and has the greatest concentration of geysers and hot springs in America. Yellowstone National Park is 2,219,789 acres in size (Larger than Rhode Island and Delaware combined). Over 97,600 acres of Yellowstone National Park is located within Gallatin County.

BELGRADE REAL ESTATE EXPERT

Delger Real Estate sold over \$155 Million in Real Estate in 2016-2023. Recognized experts in Internet Marketing and Technology, Delger Real Estate are able to generate maximum exposure for their real estate listings. The result: according to ListHub, Delger Real Estate listings outperform 98% of the market. We encourage you to contact Craig to learn more about real estate in Belgrade and the surrounding areas.

POWERED BY INTELLIGENT MARKETING, PROPRIETARY TECHNOLOGY, AND LOCAL EXPERTISE



Craig Delger
BROKER / OWNER
406.581.7504
craigdelger@gmail.com

v1.01-2026-05-30